

SURVEY NUMBER: 24-7
VOLUME: C PAGE: 1895
DATE FILED: 2-6-2024
PARCEL #: 40-1800-0000-00

ALL REGIONAL PLANNING
REQUIREMENTS HAVE BEEN
APPROVED FOR THIS SURVEY
APPLICATION # 24-7111R

REFERENCES:

- DEED VOLUMES AND PAGES AS SHOWN.
- SURVEY VOLUME 2, PAGE 35.
- SURVEY VOLUME D, PAGE 676.
- SURVEY VOLUME D, PAGE 693.
- ORIGINAL U.S. GOVERNMENT FIELD NOTES.
- WYANDOT COUNTY CORNERSTONE RECORDS.
- WYANDOT COUNTY ROAD RECORDS.

NOTE: THIS SURVEY DOES NOT INCLUDE A TITLE SEARCH.
EASEMENTS OR OTHER ENCUMBRANCES ON OR
OVER THE LAND ARE NOT SHOWN ON THIS SURVEY.
ANY BUILDINGS OR OTHER STRUCTURES NOT TO SCALE.
I HEREBY DECLARE THAT I HAVE SURVEYED THE ABOVE
DESCRIBED PROPERTY DURING FEBRUARY, 2024.
THIS SURVEY IS SUBJECT TO ALL LEGAL HIGHWAYS,
EASEMENTS, RESTRICTIONS, LEASES OF RECORD
AND OF RECORDS IN RESPECTIVE UTILITY OFFICES.
THE BEARINGS REFERRED TO HEREON ARE BASED
ON AN ASSUMED MERIDIAN AND ARE ONLY FOR
THE PURPOSE OF ANGULAR MEASUREMENT.

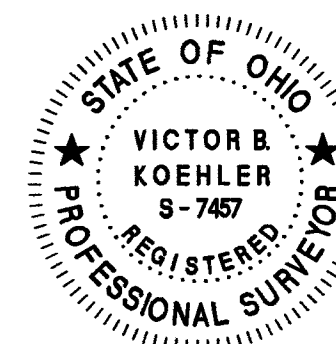

VICTOR B. KOEHLER, P.S. NO. 7457

02-02-2024
DATE

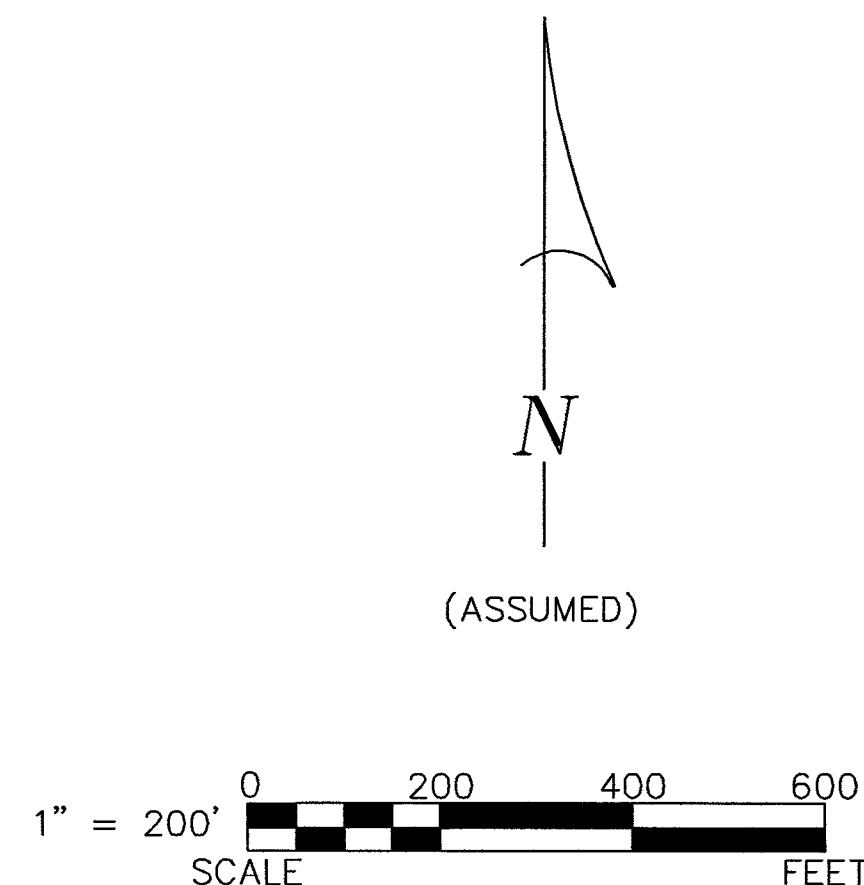

LEGEND:

SET	FOUND	DESCRIPTION
⊗	●	MONUMENT
⊕	●	RAILROAD SPIKE
○	●	NAIL
⊙	●	IRON PIPE
⊗	●	DRILL HOLE
○	●	5/8"Ø IRON ROD WITH PERSONALIZED CAP
	●	IRON ROD (5/8"Ø U.N.)
	●	STONE
	■	MONUMENT BOX
	D	DEED
	P	PLAT
	M	MEASURED
	C	CALCULATED
	Ø	DIAMETER
	SR	SURVEY RECORD
	□	HOUSE
	□	GARAGE
	□	BARN
	□	SHED
	X	FENCE
	C/L	CENTERLINE
	R/W	RIGHT-OF-WAY
	P/L	PROPERTY LINE
	■	POST

SURVEY FOR: **BENDER/WEAVER**

BEING A PARCEL OF LAND SITUATED IN PART OF
THE SOUTHWEST QUARTER OF SECTION 20, T-2-S, R-15-E,
EDEN TOWNSHIP, WYANDOT COUNTY, OHIO.

DRAWN: MSW
CHECKED: VBK
REVISIONS:

01-31-24 02-01-24
1 / 1

23035-S2

KOEHLER SURVEYING, INC.

P. O. BOX 28
UPPER SANDUSKY, OHIO 43351
419-294-5388