

SECTION OVERVIEW

NOT TO SCALE

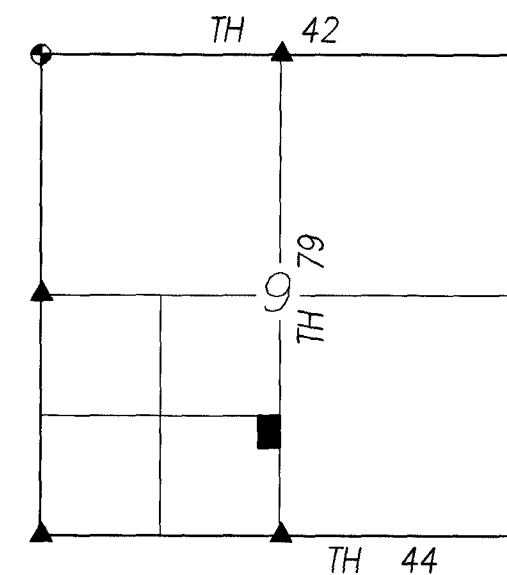

REFERENCES:

- DEED VOLUMES AND PAGES AS SHOWN.
- WYANDOT COUNTY CORNERSTONE RECORDS.
- WYANDOT COUNTY ROAD RECORDS.
- ORIGINAL U. S. GOVERNMENT FIELD NOTES.

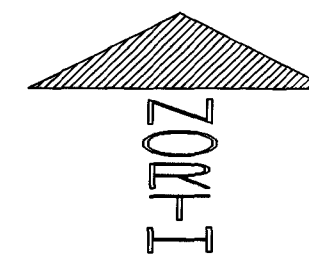

(ASSUMED)

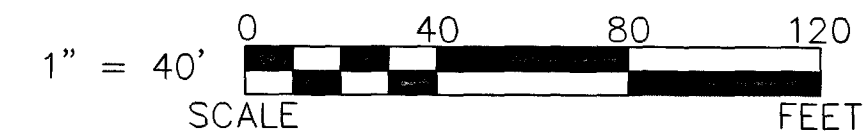

LEGEND:

SET	FOUND	DESCRIPTION
⊙	⊙	MONUMENT
⊕	⊕	RAILROAD SPIKE
⊗	⊗	NAIL
⊙	⊙	IRON PIPE
⊙	⊙	DRILL HOLE
⊙	⊙	5/8" Ø IRON ROD WITH PERSONALIZED CAP
⊙	⊙	IRON ROD
⊙	⊙	STONE
⊙	⊙	MONUMENT BOX
⊙	⊙	DEED
⊙	⊙	PLAT
⊙	⊙	MEASURED
⊙	⊙	CALCULATED
⊙	⊙	DIAMETER
⊙	⊙	SURVEY RECORD
⊙	⊙	HOUSE
⊙	⊙	GARAGE
⊙	⊙	BARN
⊙	⊙	SHED
⊙	⊙	FENCE
⊙	⊙	C/L
⊙	⊙	R/W
⊙	⊙	P/L
⊙	⊙	POST

NOTE: THIS SURVEY DOES NOT INCLUDE A TITLE SEARCH. EASEMENTS OR OTHER ENCUMBRANCES ON OR OVER THE LAND ARE NOT SHOWN ON THIS SURVEY. ANY BUILDINGS OR OTHER STRUCTURES NOT TO SCALE. I HEREBY DECLARE THAT I HAVE SURVEYED THE ABOVE DESCRIBED PROPERTY DURING JUNE, 2005. THIS SURVEY IS SUBJECT TO ALL LEGAL HIGHWAYS, EASEMENTS, RESTRICTIONS, LEASES OF RECORD AND OF RECORDS IN RESPECTIVE UTILITY OFFICES. THE BEARINGS REFERRED TO HEREON ARE BASED ON AN ASSUMED MERIDIAN AND ARE ONLY FOR THE PURPOSE OF ANGULAR MEASUREMENT.

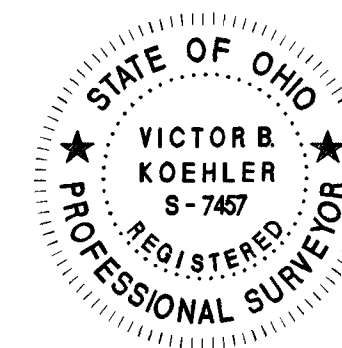

Victor B. Koehler

VICTOR B. KOEHLER, P.S. NO. 7457

06-20-05
DATE

KOEHLER SURVEYING, INC.

P. O. BOX 28
UPPER SANDUSKY, OHIO 43351
419-294-5388

SURVEY FOR: ROGER BASH

BEING A PARCEL OF LAND SITUATED IN PART OF
THE SOUTHWEST QUARTER OF SECTION 9, T-2-S, R-12-E,
RICHLAND TOWNSHIP, WYANDOT COUNTY, OHIO.

DRAWN: DAL

1

05091-S

CHECKED: VBK

06-17-05

06-17-05

06-17-05

06-17-05

06-17-05

06-17-05

06-17-05

06-17-05

06-17-05