

SURVEY NUMBER: 01104
VOLUME: C PAGE: 536
DATE FILED: 9-20-01
PARCEL #: 20-0090-0000

ALL REGIONAL PLANNING
REQUIREMENTS HAVE BEEN
APPROVED FOR THIS SURVEY
APPLICATION # 0157

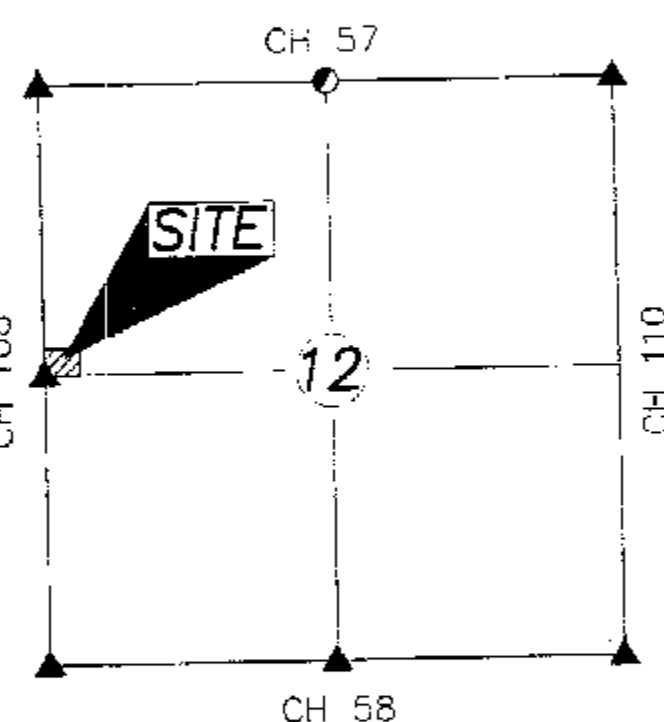

SECTION OVERVIEW
NTS

DOLA B. STANSBERRY
REVOCABLE LIVING TRUST
199 - 912

CAROL SUE HOLLANSHEAD
199 - 849

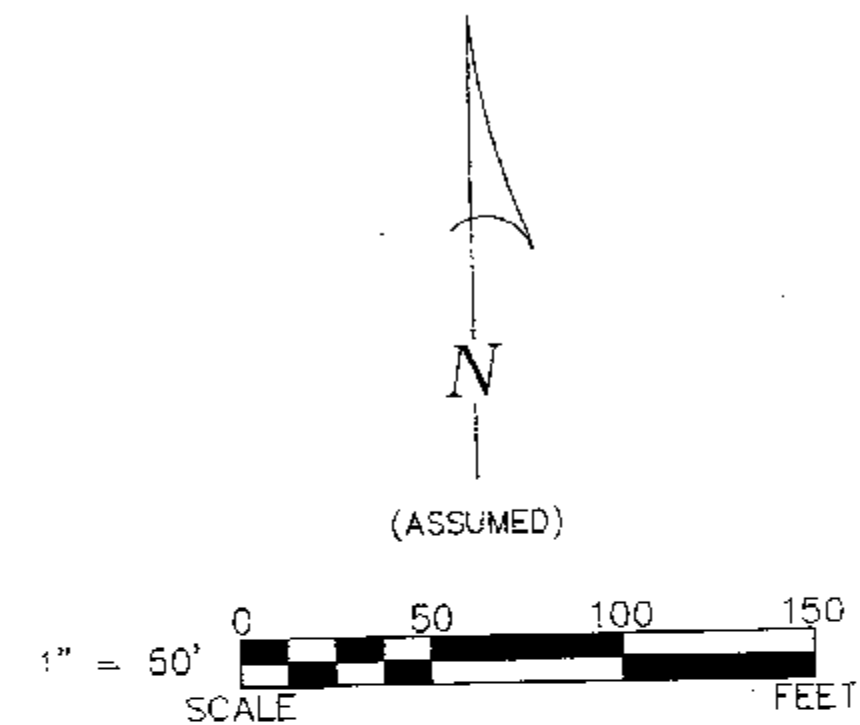

REFERENCES:

- DEED VOLUMES AND PAGES AS SHOWN.
- WYANDOT COUNTY CORNERSTONE RECORDS.
- WYANDOT COUNTY ROAD RECORDS.
- ORIGINAL U.S. GOVERNMENT FIELD NOTES.

LEGEND:

SET FOUND	DESCRIPTION
⊗	MONUMENT
⊕	RAILROAD SPIKE
⊙	NAIL
○	IRON PIPE
⊙	DRILL HOLE
⊙	5/8" IRON ROD WITH PERSONALIZED CAP
⊙	IRON ROD
●	STONE
▲	MONUMENT BOX
□	DEED
P	PLAT
M	MEASURED
C	CALCULATED
Ø	DIAMETER
SR	SURVEY RECORD
■	HOUSE
■	GARAGE
■	BARN
■	SHED
×	FENCE
C/L	CENTERLINE
R/W	RIGHT-OF-WAY
P/L	PROPERTY LINE

NOTE: THIS SURVEY DOES NOT INCLUDE A TITLE SEARCH. EASEMENTS OR OTHER ENCUMBRANCES ON OR OVER THE LAND ARE NOT SHOWN ON THIS SURVEY. ANY BUILDINGS OR OTHER STRUCTURES NOT TO SCALE. I HEREBY DECLARE THAT I HAVE SURVEYED THE ABOVE DESCRIBED PROPERTY DURING SEPTEMBER, 2001. THIS SURVEY IS SUBJECT TO ALL LEGAL HIGHWAYS, EASEMENTS, RESTRICTIONS, LEASES OF RECORD AND OF RECORDS IN RESPECTIVE UTILITY OFFICES. THE BEARINGS REFERRED TO HEREON ARE BASED ON AN ASSUMED MERIDIAN AND ARE ONLY FOR THE PURPOSE OF ANGULAR MEASUREMENT.



Victor B. Koehler
VICTOR B. KOEHLER, P.S. NO. 7457
DATE 09.14.01

KOEHLER SURVEYING
P. O. BOX 28 UPPER SANDUSKY, OHIO 43351
419-294-5388

SURVEY FOR: THE ESTATE OF DOLA B. STANSBERRY
BEING A PARCEL OF LAND SITUATED IN PART OF
THE NORTHWEST QUARTER OF SECTION 12, T-3-S, R-13-E,
MIFFLIN TOWNSHIP, WYANDOT COUNTY, OHIO.

DRAWN:	CHECKED:	REVISIONS:
DAL	VEK	
09-13-01	09-14-00	
1	1	
01153-S		