

ALTA/ACSM LAND TITLE SURVEY FOR
WORTHINGTON CUSTOM PLASTIC, INC.
AND BUCKEYE CUSTOM PRODUCTS, INC.

SITUATED IN AND BEING PART OF THE
 WEST HALF OF THE SOUTHEAST QUARTER OF
 SECTION 30, TOWNSHIP 2 SOUTH, RANGE 14 EAST
 CITY OF UPPER SANDUSKY, WYANDOT COUNTY, OHIO

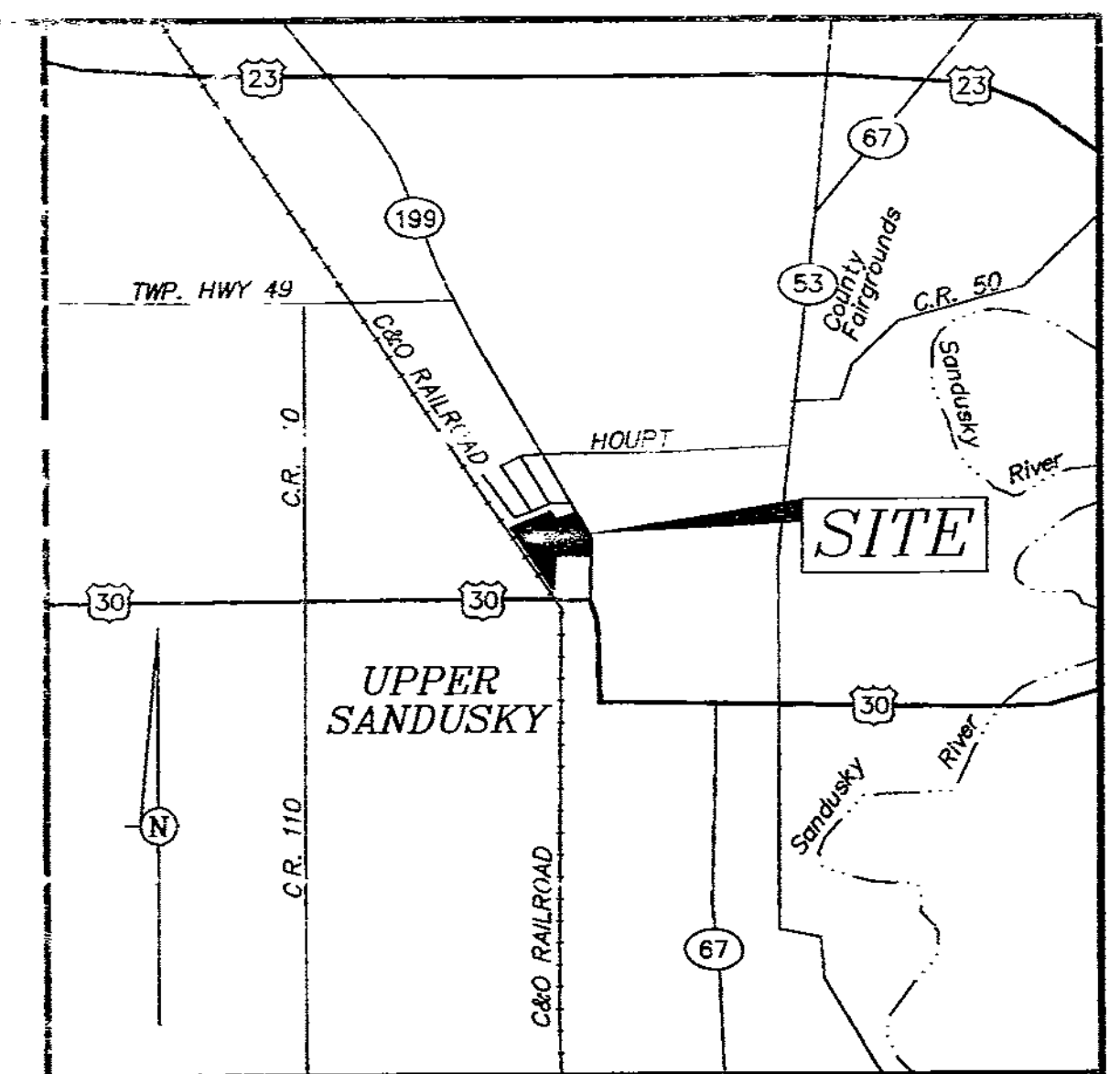

LOCATION MAP
 No Scale

LEGEND

- 3/4" IRON PIPE (FOUND/SET)
- PK NAIL (FOUND/SET)
- RAILROAD SPIKE (FOUND/SET)
- 5/8" REBAR (FOUND/SET)
- CB CATCH BASIN
- MH SEWER MANHOLE
- FIRE HYDRANT
- LIGHT OR UTILITY POLES
- SIGN POLE
- OHL— OVERHEAD UTILITY LINE
- UG— UNDERGROUND UTILITY LINE
- ST— STORM SEWER LINE
- SAN— SANITARY SEWER LINE
- W— WATER LINE
- FENCE LINE
- TREE/HEDGE ROW

ACREAGE SUMMARY

PARCEL ONE	2.452 AC.
PARCEL TWO	3.666 AC.
PARCEL THREE	6.637 AC.
PARCEL FOUR	0.232 AC.
PARCEL FIVE	1.493 AC.
PARCEL SIX	1.562 AC.
TOTAL	16.042 AC.



0 60 120
 SCALE 1 INCH = 60 FEET

Survey Number: 93-61
 Volume: D Page: 75
 Date Filed: 5-26-99
 Parcel Number:

Regional Planning Has Been
 Approved For this Survey
 See Application #: N/A

I HEREBY CERTIFY TO BANKAMERICA BUSINESS CREDIT, INC., AS AGENT, ITS SUCCESSORS AND ASSIGNS, WORTHINGTON CUSTOM PLASTICS, INC., BUCKEYE CUSTOM PRODUCTS, INC., AND FIRST AMERICAN TITLE INSURANCE COMPANY THAT THE SURVEY PREPARED BY ME ENTITLED "ALTA/ACSM LAND TITLE SURVEY FOR WORTHINGTON CUSTOM PLASTICS, INC. AND BUCKEYE CUSTOM PRODUCTS, INC." WAS ACTUALLY MADE UPON THE GROUND AND THAT IT AND THE INFORMATION, COURSES AND DISTANCES SHOWN THEREON ARE CORRECT; THAT THE TITLE LINES AND LINES OF ACTUAL POSSESSION ARE THE SAME; THAT THE SIZE, LOCATION AND TYPE OF BUILDINGS AND IMPROVEMENTS ARE AS SHOWN AND ALL ARE WITHIN THE BOUNDARY LINES OF THE PROPERTY; THAT THERE ARE NO VIOLATIONS OF ZONING ORDINANCES, RESTRICTIONS OR OTHER RULES AND REGULATIONS WITH REFERENCE TO THE LOCATION OF SAID BUILDING AND IMPROVEMENTS; THAT THERE ARE NO EASEMENTS, ENCROACHMENTS OR USE AFFECTING THIS PROPERTY APPEARING FROM A CAREFUL INSPECTION OF THE SAME, OTHER THAN THOSE SHOWN AND DEPICTED THEREON; THAT ALL UTILITY SERVICES REQUIRED FOR THE OPERATIONS OF THE PREMISES EITHER ENTER THE PREMISES THROUGH ADJOINING PUBLIC STREETS, OR THE SURVEY SHOWS THE POINT OF ENTRY AND LOCATION OF ANY UTILITIES WHICH PASS THROUGH OR ARE LOCATED ON ADJOINING PRIVATE LAND; THAT THE SURVEY SHOWS THE LOCATION AND DIRECTION OF ALL STORM DRAINAGE SYSTEMS FOR THE COLLECTION AND DISPOSAL OF ALL LAND; THAT ANY DISCHARGE INTO STREAMS, RIVERS OR OTHER CONVEYANCE SYSTEM IS SHOWN ON THE SURVEY; AND THAT THE PARCELS DESCRIBED HEREON DO NOT LIE WITHIN FLOOD HAZARD AREAS IN ACCORDANCE WITH THE DOCUMENT ENTITLED "DEPARTMENT OF HOUSING AND URBAN DEVELOPMENT, FEDERAL INSURANCE ADMINISTRATION - SPECIAL FLOOD HAZARD AREA MAPS". THIS SURVEY IS MADE IN ACCORDANCE WITH THE "MINIMUM STANDARD DETAIL REQUIREMENTS FOR LAND TITLE SURVEYS" JOINTLY ESTABLISHED AND ADOPTED BY ALTA AND ACSM IN OCTOBER, 1997, AND MEETS THE ACCURACY REQUIREMENTS OF AN "URBAN SURVEY" AS DEFINED THEREIN AND THE "OPTIONAL SURVEY RESPONSIBILITIES AND SPECIFICATIONS" SET FORTH IN TABLE A THEREOF AS ITEMS 1, 2, 3, 4, 7, 8, 10, 11, 13, 14, 15, AND 16.

Robert E. Blackburn
 ROBERT E. BLACKBURN
 OHIO PROFESSIONAL SURVEYOR NO. 6305

5/26/99
 DATE

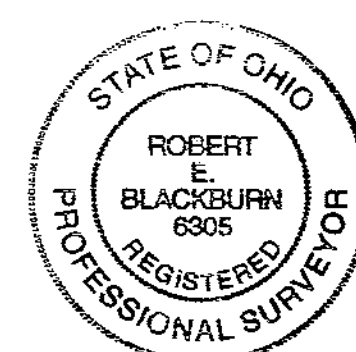

Revised: 5-25-99

Geo-Graphics Inc.
 Land Surveying & Civil Engineering
 685 North James Road Columbus, Ohio 43219
 614-231-2016

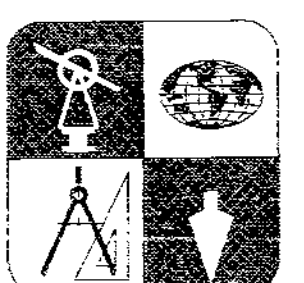

ALTA/ACSM LAND TITLE SURVEY FOR
WORTHINGTON CUSTOM PLASTIC, INC. AND
BUCKEYE CUSTOM PRODUCTS, INC.
 16.042 ACRES, 698768 SQ. FT.
 CITY OF UPPER SANDUSKY
 WYANDOT COUNTY, OHIO

SCALE 1"=60'	DRAWN KWN	CHECKED REB	DATE 5-24-99	SHEET 1 OF 1
-----------------	--------------	----------------	-----------------	-----------------