

KOEHLER SURVEYING, INC.
P.O. BOX 28
UPPER SANDUSKY, OHIO 43351
(419) 294-5388

**LEGAL DESCRIPTION OF A 0.375 ACRE PARCEL
FOR WINIFRED E. OHLINGER**

Being a parcel of land situated in part of the Northwest Quarter of Section 5, T-2-S,
R-13-E, Salem Township, Wyandot County, Ohio, and further described as follows:

Commencing at a found stone in a monument box marking the West Quarter Post of said
Section 5 and being the **POINT OF BEGINNING**;

thence on an assumed bearing of N 00° 00' 00" E along the centerline of County
Highway 96 a distance of 20.00 feet to a set MAG nail marking the southwest corner of a
parcel of land currently owned by C. E. Myers;

thence N 89° 40' 31" E along the south line of said Myers parcel a distance of 815.65 feet
to a set iron rod situated on the east line of said Myers parcel, passing a set iron rod for
reference a distance of 30.00 feet;

thence S 00° 00' 54" E a distance of 20.00 feet to a set iron rod on the east-west half
section line;

thence S 89° 40' 31" W along the east-west half section line a distance of 815.66 feet to
the **POINT OF BEGINNING**.

Containing in all 0.375 acres of land, more or less, of which 0.014 acre, more or less, is
currently contained within highway right-of-ways. The above described property being
subject to all legal highways and easements of record.

Bearings are assumed and are for angular measurement only.

All set iron rods are 5/8" diameter with personalized plastic caps.

This legal description is based upon a survey performed by Victor B. Koehler, P.S.
#7457, in February, 2014.

Prior Deed Reference – OR Volume 224, Page 2338.

13147-S

REFERENCE SURVEY VOL. D
PAGE 534 IN THE TAX MAP OFFICE

(TRACT 2)

(0.375A)

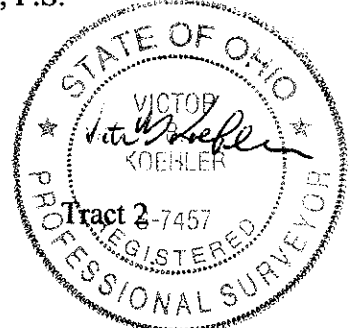

KOEHLER SURVEYING, INC.
P.O. BOX 28
UPPER SANDUSKY, OHIO 43351
(419) 294-5388

**LEGAL DESCRIPTION OF A 85.608 ACRE PARCEL
FOR WINIFRED E. OHLINGER**

Being a parcel of land situated in part of the Northwest Quarter of Section 5, T-2-S, R-13-E, Salem Township, Wyandot County, Ohio, and further described as follows:

Commencing at a found stone in a monument box marking the West Quarter Post of said Section 5;

thence on an assumed bearing of N 89° 40' 31" E along the east-west half section line a distance of 815.66 feet to a set iron rod and being the **POINT OF BEGINNING**;

thence N 00° 00' 54" W along the east line of a parcel of land owned by C. E. Myers, et ux, a distance of 2867.94 feet to a set MAG nail on the centerline of County Highway 4 marking the northeast corner of said parcel, passing a set iron rod for reference a distance of 2847.94 feet;

thence N 89° 50' 01" E along said centerline a distance of 794.90 feet to a found stone on the west line of the former Wyandot Indian Reservation;

thence S 00° 01' 48" E along said line a distance of 1151.75 feet to a set iron rod marking the southwest corner of a parcel of land currently owned by D. Fredritz;

thence N 89° 51' 38" E along said Fredritz parcel a distance of 847.74 feet to a set iron rod on the north-south half section line;

thence S 00° 15' 27" E along said half section line a distance of 1691.42 feet to a point marking the center of said Section 5, passing a set iron rod for reference a distance of 1686.42 feet;

thence S 88° 20' 51" W along the east-west half section line a distance of 854.79 feet to a set iron rod on the west line of the former Wyandot Indian Reservation;

thence S 89° 40' 31" W along the east-west half section line a distance of 795.66 feet to the **POINT OF BEGINNING**.

(TRACT)
(85.608 A)

REFERENCE SURVEY VOL. D
PAGE 534 IN THE TAX MAP OFFICE

Containing in all 85.608 acres of land, more or less, of which 0.364 acre, more or less, is currently contained within highway right-of-ways. The above described property being subject to all legal highways and easements of record.

Bearings are assumed and are for angular measurement only.

All set iron rods are 5/8" diameter with personalized plastic caps.

This legal description is based upon a survey performed by Victor B. Koehler, P.S. #7457, in February, 2014.

Prior Deed Reference – Volume 192, Page 920.

13147-S

Tract 1

