



**VAN HORN, HOOVER
& ASSOCIATES, INC.**
SURVEYING & ENGINEERING

P.O. BOX 612
FINDLAY, OHIO 45839

Ph.: (419) 423-5630
Fax: (419) 423-5772

LEGAL DESCRIPTION

FOR: Wright

Pt. NW1/4,
Section 26,
T1S, R13E,
3.500 Acres

Situated in Crawford Township, County of Wyandot, State of Ohio and being a part of the NW1/4 of Section 26, T1S, R13E, a tract of land bounded and described as follows:

Beginning at a P.K. Nail found marking the northwest corner of a tract of land previously conveyed in Deed Volume 166, Page 714 of the Wyandot County Deed Records; and referenced by a 1/2" Rebar set at S 02°24'33" W, a distance of 20.00 feet, said P.K. Nail further described as lying S 87°35'45" E, a distance of 1023.00 feet from a P.K. Nail found over a stone marking the northwest corner of said NW1/4 of Section 26;

Thence from the above described point of beginning and along the north line of said NW1/4, also being the centerline of Township Road No. 28, S 87°35'45" E, a distance of 400.00 feet to a P.K. Nail set;

Thence S 02°24'33" W, a distance of 381.15 feet to a 1/2" Rebar set and passing a 1/2" Rebar set at 20.00 feet;

Thence parallel with said north line of the NW1/4 of Section 26, N 87°35'45" W, a distance of 400.00 feet to a 1/2" Rebar set on the west line of said previously conveyed tract of land;

Thence along said west line, N 02°24'33" E, a distance of 381.15 feet to the point of beginning and passing a 1/2" Rebar set 20.00 feet south thereof and containing 3.500 Acres of land, more or less, subject however to all legal highways and prior easements of record.

NOTE: All bearings used are based on a prior survey recorded in Plat Volume C, Page 729 and are assumed for the purpose of description only.

PRIOR DEED REFERENCE: Volume 166, Page 714

DATE: 5/4/04

SURVEY & LEGAL DESCRIPTION BY:

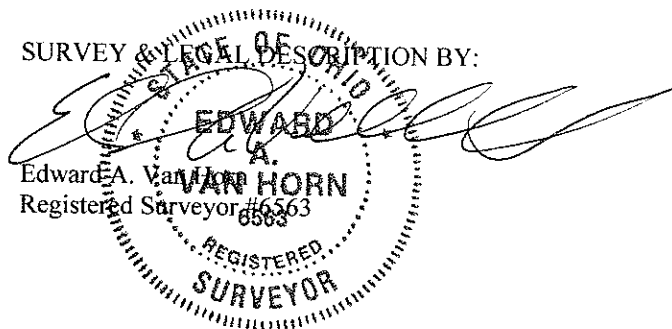

REFERENCE SURVEY VOL. D
PAGE 218 IN THE TAX MAP OFFICE