

Legal Description for Parcel 1:

Situated in the State of Ohio, County of Wyandot, Township of Tymochtee, being part of the Northwest quarter of Section 13, Township 1 South, Range 14 East, and being more particularly described as follows:

Commencing at a found railroad spike over stone in monument box at the Northwest Corner of said Section 13 and on centerline of County Highway 16, the place of beginning;

thence on an assumed bearing of North 90 degrees 00 minutes East along the north line of said Section 13 and the centerline of County Highway 16, for a distance of 205.0 feet to a found nail;

thence South 0 degrees 00 minutes East along a line for a distance of 184.0 feet (passing through a found personalized iron rod at 30 feet on right-of-way line) to a found personalized iron rod;

thence South 90 degrees 00 minutes West on a line for a distance of 187.58 feet to a found personalized iron rod;

thence North 0 degrees 00 minutes West on a line for a distance of 44.15 feet to a found personalized iron rod;

thence South 90 degrees 00 minutes West on a line for a distance of 17.42 feet to a found personalized iron rod, on the west line of said Section 13;

thence North 0 degrees 00 minutes West along the west line of said Section 13 for a distance of 139.85 feet to the place of beginning and containing 0.848 acres more or less (having 0.141 Acres in the right-of-way) but subject to all legal highways and easements of record, as surveyed by Michael C. Estep, Registered Surveyor number 7453 in July 2018.

Prior Instrument Reference: Deed O.R. Volume 158, Page 139 to 142.

Found 5/8 inch personalized iron rods 30 inches long, cap # 7453.

Said Parcel 1 subject to a Driveway Easement for Parcel 2:

Page 1 of 2

REFERENCE SURVEY VOL. C  
PAGE 1712 IN THE TAX MAP OFFICE

(PARCEL 1)  
(0.848A)

"2018"

Driveway Easement for Parcel 2 on Parcel 1:

Commencing at a found railroad spike over stone in monument box at the Northwest Corner of said Section 13 and on centerline of County Highway 16, the place of beginning;

thence on an assumed bearing of North 90 degrees 00 minutes East along the north line of said Section 13 and the centerline of County Highway 16, for a distance of 22 feet to a point;

thence South 0 degrees 00 minutes East on a line for a distance of 105.0 feet to a point;

thence South 14 degrees 29 minutes 34 seconds East on a line for a distance of 81.6 feet to a point;

thence South 90 degrees 00 minutes West on a line for a distance of 25.0 feet to a found personalized iron rod;

thence North 0 degrees 00 minutes West on a line for a distance of 44.15 feet to a found personalized iron rod;

thence South 90 degrees 00 minutes West on a line for a distance of 17.42 feet to a found personalized iron rod, on the west line of said Section 13;

thence North 0 degrees 00 minutes West along the west line of said Section 13 for a distance of 139.85 feet to the place of beginning and containing 0.094 acres more or less but subject to all legal highways and easements of record, as surveyed by Michael C. Estep, Registered Surveyor number 7453 in July 2018.

Page 2 of 2

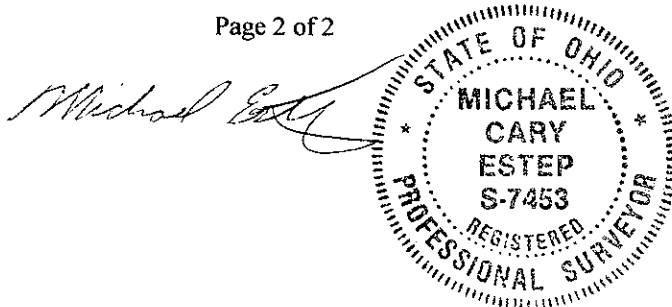

KRISTI PLT

Parcel 1

1. N 90d 00' 00" E 205.00'
  2. S 00d 00' 00" E 184.00'
  3. S 90d 00' 00" W 187.58'
  4. N 00d 00' 00" W 44.15'
  5. S 90d 00' 00" W 17.42'
  6. N 00d 00' 00" W 139.85'
- 0.848 Acres = 36,951 Sq. Ft.
- Closure 0.000'

*Michael Cary Estep*

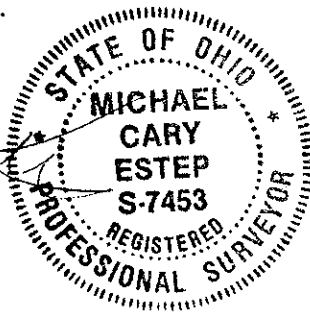

REFERENCE SURVEY VOL. d  
PAGE 1712 IN THE TAX MAP OFFICE

"2018"

Legal Description for Parcel 2:

Situated in the State of Ohio, County of Wyandot, Township of Tymochtee, being part of the Northwest quarter of Section 13, Township 1 South, Range 14 East, and being more particularly described as follows:

Commencing at a found railroad spike over stone in monument box at the Northwest Corner of Section 13 and on centerline of County Highway 16;

thence on an assumed bearing of South 0 degrees 00 minutes East along the west line of said Section 13 for a distance of 139.85 feet to a found personalized iron rod, the place of beginning;

thence North 90 degrees 00 minutes East on a line for a distance of 17.42 feet to a found personalized iron rod;

thence South 0 degrees 00 minutes East on a line for a distance of 44.15 feet to a found personalized iron rod;

thence North 90 degrees 00 minutes East on a line for a distance of 187.58 feet to a found personalized iron rod;

thence South 0 degrees 00 minutes East along a line for a distance of 86.0 feet to a found personalized iron rod;

thence South 90 degrees 00 minutes West along a line for a distance of 205.0 feet to a found personalized iron rod;

thence North 0 degrees 00 minutes West along the west line of said Section 13 for a distance of 130.15 feet to the place of beginning and containing 0.422 acres more or less but subject to all legal highways and easements of record, as surveyed by Michael C. Estep, Registered Surveyor number 7453 in July 2018.

Prior Instrument Reference: Deed O.R. Volume 158, Page 139 to 142.

Set 5/8 inch personalized iron rods 30 inches long, cap # 7453.

Said Parcel 2 is allowed a Driveway Easement on Parcel 1.

(PARCEL 2)  
(0.422A)

Driveway Easement for Parcel 2 on Parcel 1:

Commencing at a found railroad spike over stone in monument box at the Northwest Corner of said Section 13 and on centerline of County Highway 16, the place of beginning;

thence on an assumed bearing of North 90 degrees 00 minutes East along the north line of said Section 13 and the centerline of County Highway 16, for a distance of 22 feet to a point;

thence South 0 degrees 00 minutes East on a line for a distance of 105.0 feet to a point;

thence South 14 degrees 29 minutes 34 seconds East on a line for a distance of 81.6 feet to a point;

thence South 90 degrees 00 minutes West on a line for a distance of 25.0 feet to a found personalized iron rod;

thence North 0 degrees 00 minutes West on a line for a distance of 44.15 feet to a found personalized iron rod;

thence South 90 degrees 00 minutes West on a line for a distance of 17.42 feet to a found personalized iron rod, on the west line of said Section 13;

thence North 0 degrees 00 minutes West along the west line of said Section 13 for a distance of 139.85 feet to the place of beginning and containing 0.094 acres more or less but subject to all legal highways and easements of record, as surveyed by Michael C. Estep, Registered Surveyor number 7453 in July 2018.

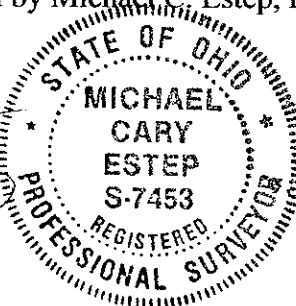
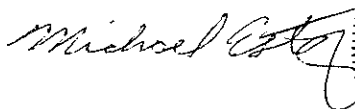

Parcel 2 RONALD.PLT

Parcel 2

1. N 90d 00' 00" E 17.42'
  2. S 00d 00' 00" E 44.15'
  3. N 90d 00' 00" E 187.58'
  4. S 00d 00' 00" E 86.00'
  5. S 90d 00' 00" W 205.00'
  6. N 00d 00' 00" W 130.15'
- 0.422 Acres = 18,399 Sq. Ft.
- Closure 0.000'

*Michael Estep*



REFERENCE SURVEY VOL. C  
PAGE 1712 IN THE TAX MAP OFFICE

" 2018 "

Legal Description for Parcel 3:

Situated in the State of Ohio, County of Wyandot, Township of Tymochtee, being part of the Northeast quarter of Section 14, Township 1 South, Range 14 East, and being more particularly described as follows:

Commencing at a found railroad spike over stone in monument box at the Northeast Corner of said Section 14 and on centerline of County Highway 16, the place of beginning;

thence on an assumed bearing of South 0 degrees 00 minutes East along the east line of said Section 14, for a distance of 139.85 feet to a found personalized iron rod;

thence South 90 degrees 00 minutes West on a line for a distance of 33.00 feet to a set personalized iron rod;

thence South 0 degrees 00 minutes East on a line for a distance of 92.35 feet to a set personalized iron rod;

thence South 90 degrees 00 minutes West on a line for a distance of 200.00 feet to a set personalized iron rod;

thence North 0 degrees 00 minutes 09 seconds East on a line for a distance of 230.00 feet (passing through a set personalized iron rod at 200.00 feet on right-of-way line) to a set nail, on centerline of County Highway 16 and on the north line of said Section 14;

thence North 89 degrees 27 minutes 38 seconds East along the centerline of County Highway 16 and the north line of said Section 14 for a distance of 233.00 feet to the place of beginning and containing 1.166 acres more or less (having 0.161 Acres in the right-of-way) but subject to all legal highways and easements of record, as surveyed by Michael C. Estep, Registered Surveyor number 7453 in October 2018.

Prior Instrument Reference: Deed O.R. Volume 158, Page 139 to 142.

Set and Found 5/8 inch personalized iron rods 30 inches long, cap # 7453.

*Michael C. Estep*

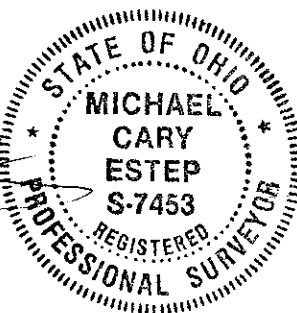

(PARCEL 3)  
(1.166A)

REFERENCE SURVEY VOL. C  
PAGE 1712 IN THE TAX MAP OFFICE  
"2018"

Parcel 3 1.166AC.PLT

Parcel 3

1. S 00d 00' 00" E 139.85'
2. S 90d 00' 00" W 33.00'
3. S 00d 00' 00" E 92.35'
4. S 90d 00' 00" W 200.00'
5. N 00d 00' 09" E 230.00'
6. N 89d 27' 38" E 233.00'

1.166 Acres

50.798 Sq. Ft.

Closure 0.006'

*Michael Cary Estep*



REFERENCE SURVEY VOL. C

PAGE 1712 IN THE TAX MAP OFFICE

"2018"



**Legal Description for Parcel 1 and 3 Combined:**

Situated in the State of Ohio, County of Wyandot, Township of Tymochtee, being part of the Northwest quarter of Section 13 and being part of the Northeast quarter of Section 14, Township 1 South, Range 14 East, and being more particularly described as follows:

Commencing at a found railroad spike over stone in monument box at the Northwest Corner of said Section 13 and on centerline of County Highway 16, the place of beginning;

thence on an assumed bearing of North 90 degrees 00 minutes East along the north line of said Section 13 and the centerline of County Highway 16, for a distance of 205.0 feet to a found nail;

thence South 0 degrees 00 minutes East along a line for a distance of 184.0 feet (passing through a found personalized iron rod at 30 feet on right-of-way line) to a found personalized iron rod;

thence South 90 degrees 00 minutes West on a line for a distance of 187.58 feet to a found personalized iron rod;

thence North 0 degrees 00 minutes West on a line for a distance of 44.15 feet to a found personalized iron rod;

thence South 90 degrees 00 minutes West on a line for a distance of 17.42 feet to a found personalized iron rod, on the west line of said Section 13;

thence South 90 degrees 00 minutes West on a line for a distance of 33.00 feet to a set personalized iron rod;

thence South 0 degrees 00 minutes East on a line for a distance of 92.35 feet to a set personalized iron rod;

thence South 90 degrees 00 minutes West on a line for a distance of 200.00 feet to a set personalized iron rod;

thence North 0 degrees 00 minutes 09 seconds East on a line for a distance of 230.00 feet (passing through a set personalized iron rod at 200.00 feet on right-of-way line) to a set nail, on centerline of County Highway 16 and on the north line of said Section 14;

thence North 89 degrees 27 minutes 38 seconds East along the centerline of County Highway 16 and the north line of said Section 14 for a distance of 233.00 feet to the place of beginning and containing 2.014 acres more or less (having 0.302 Acres in the right-of-way) but subject to all legal highways and easements of record, as surveyed by Michael C. Estep, Registered Surveyor number 7453 in October 2018.

(PARCEL 1 & 3 COMBINED)  
(2.014A)

Prior Instrument Reference: Deed O.R. Volume 158, Page 139 to 142.

Set and Found 5/8 inch personalized iron rods 30 inches long, cap # 7453.

The combined legal for Parcel 1 & 3 is subject to a Driveway Easement to Parcel 2:

Commencing at a found railroad spike over stone in monument box at the Northwest Corner of said Section 13 and on centerline of County Highway 16, the place of beginning;

thence on an assumed bearing of North 90 degrees 00 minutes East along the north line of said Section 13 and the centerline of County Highway 16, for a distance of 22 feet to a point;

thence South 0 degrees 00 minutes East on a line for a distance of 105.0 feet to a point;

thence South 14 degrees 29 minutes 34 seconds East on a line for a distance of 81.6 feet to a point;

thence South 90 degrees 00 minutes West on a line for a distance of 25.0 feet to a found personalized iron rod;

thence North 0 degrees 00 minutes West on a line for a distance of 44.15 feet to a found personalized iron rod;

thence South 90 degrees 00 minutes West on a line for a distance of 17.42 feet to a found personalized iron rod, on the west line of said Section 13;

thence North 0 degrees 00 minutes West along the west line of said Section 13 for a distance of 139.85 feet to the place of beginning and containing 0.094 acres more or less but subject to all legal highways and easements of record, as surveyed by Michael C. Estep, Registered Surveyor number 7453 in July 2018.

Page 2 of 2

*Michael C. Estep*



2.014AC.PLT

Parecl 1 and 3 combined

1. N 90d 00' 00" E 205.00'
2. S 00d 00' 00" E 184.00'
3. S 90d 00' 00" W 187.58'
4. N 00d 00' 00" W 44.15'
5. S 90d 00' 00" W 50.42'
6. S 00d 00' 00" E 92.35'
7. S 90d 00' 00" W 200.00'
8. N 00d 00' 09" E 230.00'
9. N 89d 27' 38" E 233.00'

2.014 Acres

87,749 Sq. Ft.

Closure 0.006'

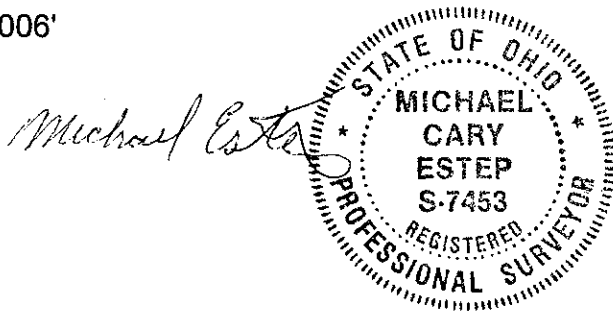

REFERENCE SURVEY VOL. 2

PAGE 1712 IN THE TAX MAP OFFICE

"2018"