

KOEHLER SURVEYING, INC.
P.O. BOX 28
UPPER SANDUSKY, OHIO 43351
(419) 294-5388

**LEGAL DESCRIPTION OF A 0.072 ACRE PARCEL
FOR D. & J. KELLER**

Being a parcel of land situated in part of fractional Lot 21 of the South Sycamore Addition, in the Village of Sycamore, Wyandot County, Ohio, and further described as follows:

Commencing at a set drill hole in concrete on the east right-of-way line of Sycamore Street marking the southwest corner of said Lot 21 and being the **POINT OF BEGINNING**;

thence on an assumed bearing of N 02° 12' 45" W along said right-of-way line and the west line of said Lots 21 a distance of 71.53 feet to a point, passing a found drill hole in concrete for reference a distance of 67.63 feet;

thence an arc distance of 89.40 feet on a curve to the left having a radius of 2576.31 feet, a chord of 89.39 feet and a chord bearing of S 53° 22' 47" E to a found iron rod;

thence S 54° 22' 25" E a distance of 24.86 feet to a set iron rod on the south line of said Lot 21;

thence S 87° 38' 18" W along the south line of said Lot 21 a distance of 89.26 feet to the **POINT OF BEGINNING**.

Containing in all 0.072 acres of land, more or less, being subject to all legal highways and easements of record.

Bearings are assumed and are for angular measurement only.

All set iron rods are 5/8" diameter with personalized plastic caps.

This legal description is based upon a survey performed by Victor B. Koehler, P.S. #7457, in June, 2013.

Prior Deed Reference – Volume 208, Page 628

13068-S

(SOUTH SYCAMORE - LOT 21)
REFERENCE SURVEY VOL. C
PAGE 1447 IN THE TAX MAP OFFICE
(TRACT 4) (Combo -
(0.072A)



KOEHLER SURVEYING, INC.
P.O. BOX 28
UPPER SANDUSKY, OHIO 43351
(419) 294-5388

**LEGAL DESCRIPTION OF A 0.066 ACRE PARCEL
FOR D. & J. KELLER**

Being a parcel of land situated in part of fractional Lot 21 of the South Sycamore Addition, in the Village of Sycamore, Wyandot County, Ohio, and further described as follows:

Commencing at a set drill hole in concrete on the east right-of-way line of Sycamore Street marking the southwest corner of said Lot 21 and being the **POINT OF BEGINNING**;

thence on an assumed bearing of N 02° 12' 45" W along said right-of-way line and the west line of said Lot 21 a distance of 67.63 feet to a found drill hole;

thence an arc distance of 87.00 feet on a curve to the left having a radius of 2579.31 feet, a chord of 87.00 feet and a chord bearing of S 53° 24' 26" E to a set iron rod;

thence N 35° 37' 35" E a distance of 3.00 feet to a found iron rod a southwesterly line of a parcel of land currently owned by B. Bills (former railroad property);

thence S 54° 22' 25" E along said line a distance of 24.86 feet to a set iron rod on the south line of said Lot 21;

thence S 87° 38' 18" W along the south line of said Lot 21 a distance of 89.26 feet to the **POINT OF BEGINNING**.

Containing in all 0.066 acres of land, more or less, being subject to all legal highways and easements of record.

Bearings are assumed and are for angular measurement only.

All set iron rods are 5/8" diameter with personalized plastic caps.

This legal description is based upon a survey performed by Victor B. Koehler, P.S. #7457, in June, 2013.

Prior Deed Reference – Volume 208, Page 628
13068-S

SOUTH SYCAMORE - LOT 21

REFERENCE SURVEY VOL. C
PAGE 1447 IN THE TAX MAP OFFICE

(TRACT 1) (0.066A)

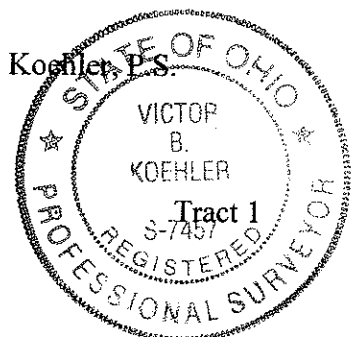

KOEHLER SURVEYING, INC.
P.O. BOX 28
UPPER SANDUSKY, OHIO 43351
(419) 294-5388

**LEGAL DESCRIPTION OF A 0.047 ACRE PARCEL
FOR H. McDERMOTT, JR.**

Being a parcel of land situated in part of fractional Lot 20 of the South Sycamore Addition, in the Village of Sycamore, Wyandot County, Ohio, and further described as follows:

Commencing at a set drill hole in concrete on the east right-of-way line of Sycamore Street marking the northwest corner of said Lot 20 and being the **POINT OF BEGINNING**;

thence on an assumed bearing of N 87° 38' 18" E along the north line of said Lot 20 a distance of 89.26 feet to a set iron rod on the southwesterly line of a parcel of land currently owned by B. Bils (former railroad property);

thence S 54° 22' 25" E along said line a distance of 32.48 feet to a set iron rod marking the northeast corner of a parcel of land currently owned by T. Rank;

thence S 87° 38' 18" W along said Rank parcel a distance of 114.91 feet to a set drill hole in concrete on the east right-of-way line of Sycamore Street marking the northwest corner of said Rank parcel;

thence N 02° 12' 45" W along said right-of-way line a distance of 19.99 feet to the **POINT OF BEGINNING**.

Containing in all 0.047 acres of land, more or less, being subject to all legal highways and easements of record.

Bearings are assumed and are for angular measurement only.

All set iron rods are 5/8" diameter with personalized plastic caps.

This legal description is based upon a survey performed by Victor B. Koehler, P.S. #7457, in June, 2013.

Prior Deed Reference – Volume 209, Page 924
13076-S

SOUTH SYCAMORE- LOT 20
REFERENCE SURVEY VOL. 6
PAGE 1447 IN THE TAX MAP OFFICE
(TRACT 2) (0.047A)

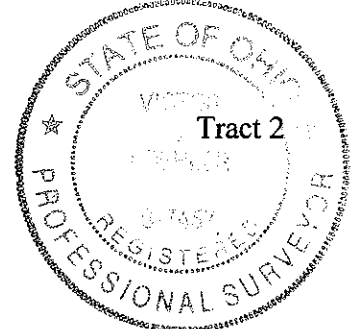

KOEHLER SURVEYING, INC.
P.O. BOX 28
UPPER SANDUSKY, OHIO 43351
(419) 294-5388

**LEGAL DESCRIPTION OF A 0.006 ACRE PARCEL
FOR D. & J. KELLER**

Being a parcel of land situated in part of fractional Lot 21 of the South Sycamore Addition, in the Village of Sycamore, Wyandot County, Ohio, and further described as follows:

Commencing at a set drill hole in concrete on the east right-of-way line of Sycamore Street marking the southwest corner of Lot 21;

thence on an assumed bearing of N 02° 12' 45" W along said right-of-way line and the west line of said Lot 21 a distance of 67.63 feet to a found drill hole and being the **POINT OF BEGINNING**;

thence continuing N 02° 12' 45" W along said right-of-way line and the west line of said Lot 21 a distance of 3.90 feet to a point, referenced by the last mentioned found drill hole.

thence an arc distance of 89.40 feet on a curve to the left having a radius of 2576.31 feet, a chord of 89.39 feet and a chord bearing of S 53° 22' 47" E to a found iron rod;

thence S 35° 37' 35" W a distance of 3.00 feet to a set iron rod;

thence an arc distance of 87.00 feet on a curve to the right having a radius of 2579.31 feet, a chord of 87.00 feet and a chord bearing of N 53° 24' 26" W to the **POINT OF BEGINNING**.

Containing in all 0.006 acres of land, more or less, being subject to all legal highways and easements of record.

Bearings are assumed and are for angular measurement only.

All set iron rods are 5/8" diameter with personalized plastic caps.

This legal description is based upon a survey performed by Victor B. Koehler, P.S. #7457, in June, 2013.

Prior Deed Reference – Volume 210, Page 986
13068-S

SOUTH SYCAMORE - LOT 21

REFERENCE SURVEY VOL. 6
PAGE 1447 IN THE TAX MAP OFFICE

(TRACT 3)(0.006A)

