



ENGINEERS • SURVEYORS

1810 E. Mansfield St.
P.O. Box 325
Bucyrus, Ohio 44820
(419) 562-7757
(419) 562-4717 fax

**LEGAL DESCRIPTION FOR DENNIS RHODES
8.923 ACRES
COUNTY OF WYANDOT, OHIO
TRACT 1**

SITUATED IN THE STATE OF OHIO, COUNTY OF WYANDOT, BEING PART OF THE NORTHEAST QUARTER OF FRACTIONAL SECTION 5, TOWNSHIP 4 SOUTH, RANGE 15 EAST, ANTRIM TOWNSHIP, BEING A 8.923 ACRE TRACT OUT OF A TRACT CONVEYED TO R. DENNIS RHODES OF RECORD IN DEED BOOK 191, PAGE 875, RECORDS REFER TO THE COUNTY RECORDER'S OFFICE, WYANDOT COUNTY, OHIO AND BEING MORE PARTICULARLY DESCRIBED AS FOLLOWS;

BEGINNING FOR REFEERENCE AT A RAILROAD SPIKE FOUND OVER A STONE AT THE SOUTHEAST CORNER OF THE NORTHEAST QUARTER OF SAID FRACTIONAL SECTION 5, SAID RAILROAD SPIKE ALSO BEING AT THE CENTERLINE INTERSECTION OF TOWNSHIP HIGHWAY 72 (40 FEET IN WIDTH), AND TOWNSHIP HIGHWAY 135a (40 FEET IN WIDTH);

THENCE NORTH 00°09'59" EAST, A DISTANCE OF 1282.40 FEET WITH THE CENTERLINE OF SAID TOWNSHIP HIGHWAY 135a, AND THE EAST LINE OF SAID FRACTIONAL SECTION 5 TO A RAILROAD SPIKE FOUND OVER A STONE AT THE POINT OF BEGINNING, SAID RAILROAD SPIKE BEING REFERENCED BY A 5/8" IRON PIN FOUND SOUTH 89°52'49" WEST, A DISTANCE OF 20.00 FEET, SAID RAILROAD SPIKE ALSO BEING AT A SOUTHEAST CORNER OF SAID RHODES TRACT, AND AT A NORTHEAST CORNER OF A TRACT CONVEYED TO MAKEN BACON FARMS INC. OF RECORD IN DEED BOOK 168, PAGE 317;

THENCE SOUTH 89°52'49" WEST, A DISTANCE OF 712.29 FEET WITH THE SOUTH LINE OF SAID RHODES TRACT AND A NORTH LINE OF SAID MAKEN BACON FARMS INC. TRACT, PASSING SAID IRON PIN FOUND AT 20.00 FEET, TO A 5/8" IRON PIN FOUND;

THENCE NORTH 00°09'50" WEST, A DISTANCE OF 630.33 FEET WITH A WEST LINE OF SAID RHODES TRACT, AND AN EAST LINE OF SAID MAKEN BACON FARMS INC. TRACT TO A 5/8" IRON PIN FOUND ON THE SOUTH LINE OF A TRACT CONVEYED TO GERALD SHEAFFER, LE, ETAL OF RECORD IN OFFICIAL RECORD 135, PAGE 684;

THENCE SOUTH 89°59'00" EAST, A DISTANCE OF 472.29 FEET WITH A NORTH LINE OF SAID RHODES TRACT, AND A SOUTH LINE OF SAID SHEAFFER TRACT TO 5/8" IRON PIN SET AT A SOUTHWEST CORNER OF A TRACT CONVEYED TO WILLIAM D. GRAHAM, ETAL OF RECORD IN DEED BOOK 199, PAGE 314, & DEED BOOK 182, PAGE 167;

THENCE SOUTH 00°09'50" EAST, A DISTANCE OF 248.71 FEET OVER AND ACROSS SAID RHODES TRACT, WITH A NEW LINE, TO A 5/8" IRON PIN SET;

REFERENCE SURVEY VOL. C
PAGE 1048 IN THE TAX MAP OFFICE

THENCE SOUTH 89°59'00" EAST, A DISTANCE OF 240.00 FEET OVER AND ACROSS SAID RHODES TRACT, WITH A NEW LINE, PASSING A 5/8" IRON PIN FOUND AT 220.00 FEET TO A RAILROAD SPIKE FOUND IN THE CENTERLINE OF SAID TOWNSHIP HIGHWAY 135a;

THENCE SOUTH 00°09'50" EAST, A DISTANCE OF 379.93 FEET WITH THE CENTERLINE OF SAID TOWNSHIP HIGHWAY 135a, AND THE EAST LINE OF SAID FRACTIONAL SECTION 5 TO THE RAILROAD SPIKE FOUND OVER A STONE AT THE POINT OF BEGINNING, AND CONTAINING 8.923 ACRES OF LAND, OF WHICH 0.174 ACRES ARE IN THE RIGHT-OF-WAY, MORE OR LESS.

THE ABOVE DESCRIPTION WAS BASED ON A SURVEY PREPARED BY MAKEEVER AND ASSOCIATES, INC. UNDER THE DIRECT SUPERVISION OF BRETT R. TIEBEN, P.S. PROFESSIONAL SURVEYOR NUMBER 8191, DATED DECEMBER, 2006, AND IS SUBJECT TO ALL HIGHWAYS, EASEMENTS, AND RESTRICTIONS OF RECORD.

ALL BEARINGS ARE TO AN ASSUMED AZIMUTH AND ARE USED TO DENOTE ANGLES ONLY.

ALL IRON PINS SET ARE 5/8" O.D. X 30" LONG REINFORCING RODS WITH YELLOW PLASTIC CAPS STAMPED "MAKEEVER AND ASSOC." UNLESS OTHERWISE NOTED.

PRIOR DEED REFERENCE: DEED BOOK 191, PAGE 875.

Brett R. Tieben
BRETT R. TIEBEN, R.S.
PROFESSIONAL SURVEYOR NO. 8191
DATED: 12-14-06

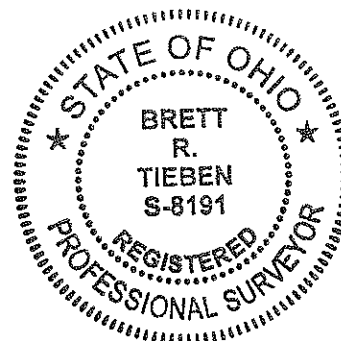



ENGINEERS • SURVEYORS

1810 E. Mansfield St.
P.O. Box 325
Bucyrus, Ohio 44820
(419) 562-7757
(419) 562-4717 fax

**LEGAL DESCRIPTION FOR DENNIS RHODES
0.370 ACRES
COUNTY OF WYANDOT, OHIO
TRACT 2**

SITUATED IN THE STATE OF OHIO, COUNTY OF WYANDOT, BEING PART OF THE NORTHEAST QUARTER OF FRACTIONAL SECTION 5, TOWNSHIP 4 SOUTH, RANGE 15 EAST, ANTRIM TOWNSHIP, BEING A 0.370 ACRE TRACT OUT OF A TRACT CONVEYED TO R. DENNIS RHODES OF RECORD IN DEED BOOK 191, PAGE 875, RECORDS REFER TO THE COUNTY RECORDER'S OFFICE, WYANDOT COUNTY, OHIO AND BEING MORE PARTICULARLY DESCRIBED AS FOLLOWS;

BEGINNING FOR REFERENCE AT A RAILROAD SPIKE FOUND OVER A STONE AT THE SOUTHEAST CORNER OF THE NORTHEAST QUARTER OF SAID FRACTIONAL SECTION 5, SAID RAILROAD SPIKE ALSO BEING AT THE CENTERLINE INTERSECTION OF TOWNSHIP HIGHWAY 72 (40 FEET IN WIDTH), AND TOWNSHIP HIGHWAY 135a (40 FEET IN WIDTH);

THENCE NORTH 00°09'59" EAST, A DISTANCE OF 1282.40 FEET WITH THE CENTERLINE OF SAID TOWNSHIP HIGHWAY 135a, AND THE EAST LINE OF SAID FRACTIONAL SECTION 5 TO A RAILROAD SPIKE FOUND OVER A STONE, SAID RAILROAD SPIKE BEING REFERENCED BY A 5/8" IRON PIN FOUND SOUTH 89°52'49" WEST, A DISTANCE OF 20.00 FEET, SAID RAILROAD SPIKE ALSO BEING AT A SOUTHEAST CORNER OF SAID RHODES TRACT, AND AT A NORTHEAST CORNER OF A TRACT CONVEYED TO MAKEN BACON FARMS INC. OF RECORD IN D.B. 168, PAGE 317;

THENCE NORTH 00°09'50" WEST, A DISTANCE OF 379.93 FEET WITH THE CENTERLINE OF SAID TOWNSHIP HIGHWAY 135a, AND THE EAST LINE OF SAID FRACTIONAL SECTION 5 TO A RAILROAD SPIKE FOUND AT THE POINT OF BEGINNING, SAID RAILROAD SPIKE BEING REFERENCED BY A 5/8" IRON PIN FOUND NORTH 89°59'00" WEST, A DISTANCE OF 20.00 FEET;

THENCE NORTH 89°59'00" WEST, A DISTANCE OF 240.00 FEET OVER AND ACROSS SAID RHODES TRACT, WITH A NEW LINE, PASSING SAID IRON PIN FOUND AT 20.00 FEET, TO A 5/8" IRON PIN SET;

THENCE NORTH 00°09'50" WEST, A DISTANCE OF 248.71 FEET OVER AND ACROSS SAID RHODES TRACT, WITH A NEW LINE, TO A 5/8" IRON PIN SET AT THE SOUTHWEST CORNER OF A TRACT CONVEYED TO WILLIAM D. GRAHAM, ETAL OF RECORD IN DEED BOOK 199, PAGE 314, & DEED BOOK 182, PAGE 167;

THENCE SOUTH 89°59'00" EAST, A DISTANCE OF 31.29 FEET WITH A NORTH LINE OF SAID RHODES TRACT, A SOUTH LINE OF SAID GRAHAM TRACT TO A 5/8" IRON PIN FOUND;

THENCE SOUTH 00°09'50" EAST, A DISTANCE OF 208.71 FEET WITH A WEST LINE OF SAID GRAHAM TRACT, AND AN EAST LINE OF SAID RHODES TRACT TO A 5/8" IRON PIN FOUND;

THENCE SOUTH 89°59'00" EAST, A DISTANCE OF 208.71 FEET WITH A NORTH LINE OF SAID RHODES TRACT, AND A SOUTH LINE OF SAID GRAHAM TRACT, PASSING A 5/8" IRON PIN FOUND AT 188.71 FEET, TO A RAILROAD SPIKE FOUND IN THE CENTERLINE OF SAID TOWNSHIP HIGHWAY 135a, AND THE EAST LINE OF SAID FRACTIONAL SECTION 5;

THENCE SOUTH 00°09'50" EAST, A DISTANCE OF 40.00 FEET WITH THE CENTERLINE OF SAID TOWNSHIP HIGHWAY 135a, AND THE EAST LINE OF SAID FRACTIONAL SECTION 5 TO THE RAILROAD SPIKE FOUND AT THE POINT OF BEGINNING, AND CONTAINING 0.370 ACRES OF LAND, OF WHICH 0.018 ACRES ARE IN THE RIGHT-OF-WAY, MORE OR LESS.

THE ABOVE DESCRIPTION WAS BASED ON A SURVEY PREPARED BY MAKEEVER AND ASSOCIATES, INC. UNDER THE DIRECT SUPERVISION OF BRETT R. TIEBEN, P.S. PROFESSIONAL SURVEYOR NUMBER 8191, DATED DECEMBER 2006, AND IS SUBJECT TO ALL HIGHWAYS, EASEMENTS, AND RESTRICTIONS OF RECORD.

ALL BEARINGS ARE TO AN ASSUMED AZIMUTH AND ARE USED TO DENOTE ANGLES ONLY.

ALL IRON PINS SET ARE 5/8" O.D. X 30" LONG REINFORCING RODS WITH YELLOW PLASTIC CAPS STAMPED "MAKEEVER AND ASSOC." UNLESS OTHERWISE NOTED.

PRIOR DEED REFERENCE: DEED BOOK 191, PAGE 875.

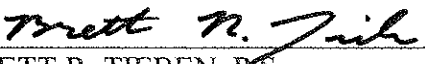
BRETT R. TIEBEN, P.S.
PROFESSIONAL SURVEYOR NO. 8191
DATED: 12-14-06

