

Legal Description parcel 2

BEING A PARCEL, WHICH HAS ITS ORIGINS IN PARCELS, CONVEYED IN OFFICIAL RECORD BOOK 238 AT PAGE 717 WHICH IS SITUATED IN THE STATE OF OHIO, COUNTY OF WYANDOT, TOWNSHIP OF SYCAMORE, VILLAGE OF SYCAMORE, KLAHR ADDITION [WYANDOT RECORDER'S SLIDES 264 AND 265] AND BEING PARTS OF LOTS 32 AND 33 OF SAID ADDITION IN TOWNSHIP 1 SOUTH, RANGE 15 EAST AND BEING MORE PARTICULARLY DESCRIBED AS FOLLOWS.

BEGINNING AT A HALF INCH IRON PIPE SET WITH CAP 5647 AT THE NORTHEAST CORNER OF SAID LOT 33.

THENCE ON AN ASSUMED BEARING OF SOUTH 00 DEGREES, 10 MINUTES, 37 SECONDS EAST (THIS BEARING IS ASSUMED AND ALL OTHER BEARINGS ARE FROM ANGLES AND DISTANCES MEASURED IN THE FIELD) ALONG THE EAST LINE LOTS 33 AND LOT 32 FOR A DISTANCE OF 120.54 FEET TO A HALF INCH IRON PIPE SET ON THE SOUTH LINE OF LOT 32.

THENCE NORTH 89 DEGREES 57 MINUTES, 01 SECONDS WEST ON SAID LINE FOR A DISTANCE OF 90.00 FEET TO A HALF INCH IRON PIPE SET WITH CAP 5647.

THENCE NORTH 00 DEGREES, 10 MINUTES, 37 SECONDS WEST ON A LINE FOR A DISTANCE OF 120.54 FEET TO A HALF INCH IRON PIPE SET WITH CAP 5647 ON THE NORTH LINE OF SAID LOT 33.

THENCE SOUTH 89 DEGREES 57 MINUTES 01 SECONDS EAST ON SAID LINE FOR A DISTANCE OF 90.00 FEET TO A HALF INCH IRON PIPE SET.

THE PLACE OF BEGINNING AND CONTAINING 0.249 ACRES MORE OR LESS BUT SUBJECT TO ALL LEGAL HIGHWAYS AND EASEMENTS OF RECORD AS SURVEYED BY JERRY B. WEININGER, REGISTERED SURVEYOR #5647 OF 6569 COUNTY HIGHWAY 2, McCUTCHENVILLE, OHIO 44844-0186 IN APRIL 18, 2016.



Jerry B. Weininger

(PARCEL 2) (0.249A)

(KLAHR'S ADDITION)

REFERENCE SURVEY VOL. B
PAGE 151 IN THE TAX MAP OFFICE

2016

Parcel 2



Scale: 1 Inch = 23 Feet
Area: 0.249 Acres (10,848.51 Square Feet)

Parcel 2

Area: 0.249 Acres (10,848.51 Square Feet)
Perimeter: 421.08 Feet
Gap = 0.000

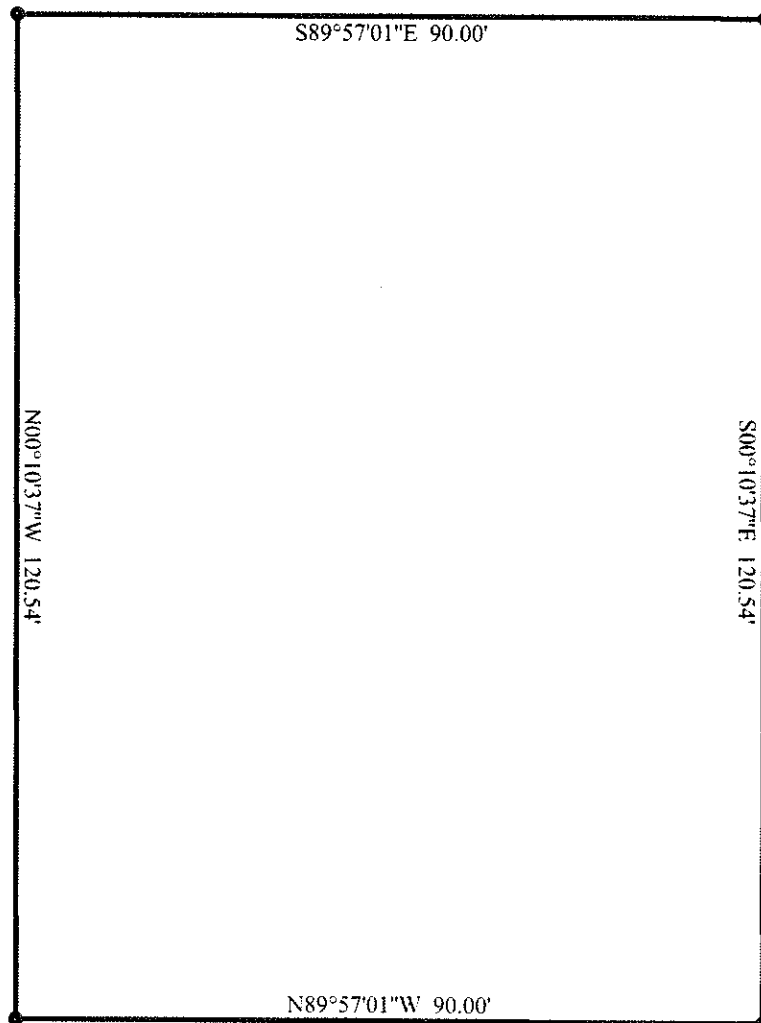

Errors and Omissions Excepted.

1. S00°10'37\"/>

REFERENCE SURVEY VOL. B
PAGE 151 IN THE TAX MAP OFFICE

2016

Legal Description parcel 1

BEING A PARCEL, WHICH HAS ITS ORIGINS IN PARCELS, CONVEYED IN OFFICIAL RECORD BOOK 238 AT PAGE 717 WHICH IS SITUATED IN THE STATE OF OHIO, COUNTY OF WYANDOT, TOWNSHIP OF SYCAMORE, VILLAGE OF SYCAMORE, KLAHR ADDITION [WYANDOT RECORDER'S SLIDES 264 AND 265] AND BEING PARTS OF LOTS 32 AND 33 OF SAID ADDITION IN TOWNSHIP 1 SOUTH, RANGE 15 EAST AND BEING MORE PARTICULARLY DESCRIBED AS FOLLOWS.

BEGINNING AT A HALF INCH IRON PIPE SET WITH CAP 5647 AT THE NORTHWEST CORNER OF SAID LOT 33.

THENCE ON AN ASSUMED BEARING OF SOUTH 89 DEGREES, 57 MINUTES, 01 SECONDS EAST (THIS BEARING IS ASSUMED AND ALL OTHER BEARINGS ARE FROM ANGLES AND DISTANCES MEASURED IN THE FIELD) ALONG THE NORTH LINE LOT 33 FOR A DISTANCE OF 90.00 FEET TO A HALF INCH IRON PIPE SET.

THENCE SOUTH 00 DEGREES 10 MINUTES, 37 SECONDS EAST ON A LINE FOR A DISTANCE OF 120.54 FEET TO A HALF INCH IRON PIPE SET WITH CAP 5647 SET ON THE SOUTH LINE OF LOT 32.

THENCE NORTH 89 DEGREES 57 MINUTES 01 SECONDS WEST ON SAID LINE FOR A DISTANCE OF 90.00 FEET TO A HALF INCH IRON PIPE SET ON THE WEST LINE OF LOT 32.

THENCE NORTH 00 DEGREES 10 MINUTES 37 SECONDS WEST ON SAID LINE AND THE WEST LINE OF LOT 33 FOR A DISTANCE OF 120.54 TO

THE PLACE OF BEGINNING AND CONTAINING 0.249 ACRES MORE OR LESS BUT SUBJECT TO ALL LEGAL HIGHWAYS AND EASEMENTS OF RECORD AS SURVEYED BY JERRY B. WEININGER, REGISTERED SURVEYOR #5647 OF 6569 COUNTY HIGHWAY 2, McCUTCHENVILLE, OHIO 44844-0186 IN APRIL 18, 2016.

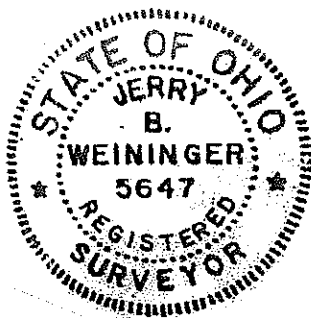

Jerry B. Weininger

(PARCEL 1) (0.249A)

(KLAHR'S ADDITION)

REFERENCE SURVEY VOL. 8
PAGE 151 IN THE TAX MAP OFFICE

"2016"

PARCEL 1



Scale: 1 Inch = 23 Feet
Area: 0.249 Acres (10,848.51 Square Feet)

Parcel 1

Area: 0.249 Acres (10,848.51 Square Feet)
Perimeter: 421.08 Feet
Gap = 0.000

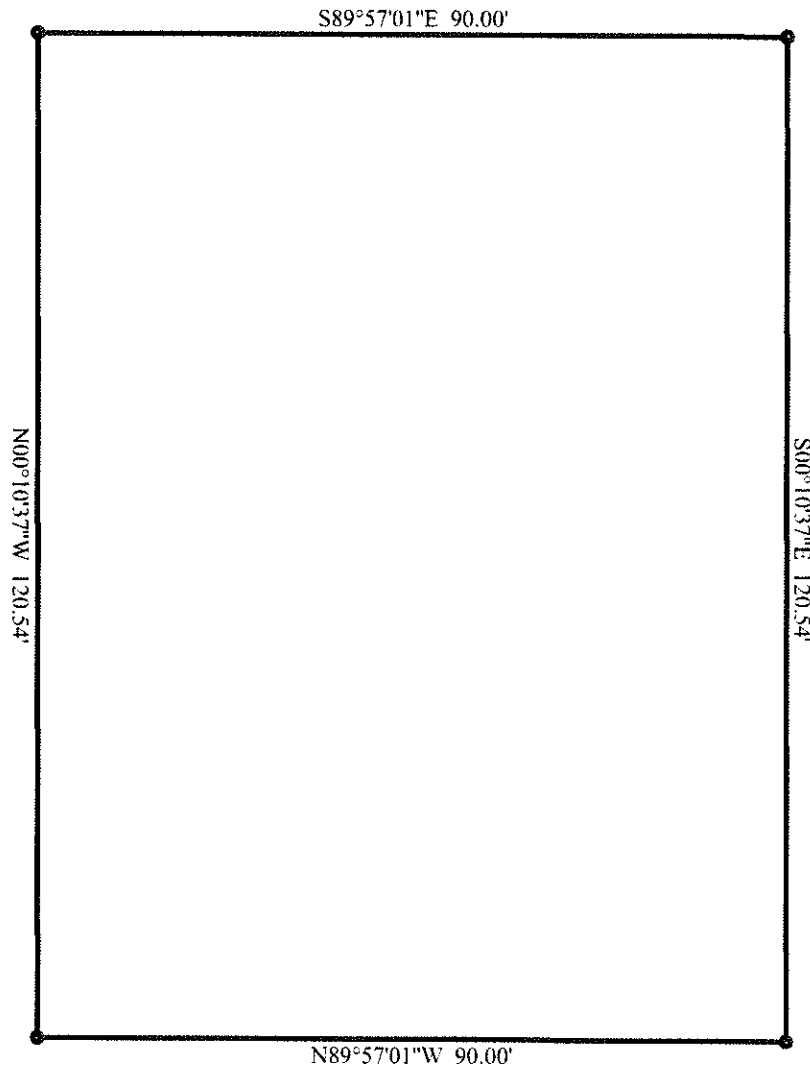

Errors and Omissions Excepted.

1. S89°57'01"E 90.00'
2. S00°10'37"E 120.54'
3. N89°57'01"W 90.00'
4. N00°10'37"W 120.54'

REFERENCE SURVEY VOL. 4 B
PAGE 151 IN THE TAX MAP OFFICE

2016