

Legal Description

BEING A PARCEL, WHICH HAS ITS ORIGINS IN PARCELS, CONVEYED IN OFFICIAL RECORD BOOK 183 AT PAGE 848 AND BOOK 202 PAGE 2412 WHICH IS SITUATED IN THE STATE OF OHIO, COUNTY OF WYANDOT, TOWNSHIP OF RIDGE AND BEING PART OF THE SOUTHEAST QUARTER OF SECTION 22 AND PART OF THE SOUTHWEST QUARTER OF SECTION 23, TOWNSHIP 1 SOUTH, RANGE 12 EAST AND BEING MORE PARTICULARLY DESCRIBED AS FOLLOWS:

BEGINNING AT AN RAILROAD SPIKE FOUND AT EAST QUARTERPOST OF SAID SECTION 22 [SEE PLAT FOR REFERENCE].

THENCE ON AN ASSUMED BEARING OF SOUTH 00 DEGREES, 00 MINUTES, 00 SECONDS WEST (THIS BEARING IS ASSUMED AND ALL OTHER BEARINGS ARE FROM ANGLES AND DISTANCES MEASURED IN THE FIELD) ALONG A LINE WHICH IS SQAURE OFF TOWNSHIP HIGHWAY 23 FOR A DISTANCE OF 768.44 FEET TO A HALF INCH IRON PIPE SET WITH CAP 5647 AND HAVING PASSED THROUGH A HALF INCH IRON PIPE SET AT 20 FEET.

THENCE SOUTH 90 DEGREES 00 MINUTES, 00 SECONDS WEST ON A LINE FOR A DISTANCE OF 730.94 FEET TO A HALF INCH IRON PIPE SET WITH CAP 5647.

THENCE NORTH 00 DEGREES, 00 MINUTES, 00 SECONDS EAST ON A LINE FOR A DISTANCE OF 768.44 FEET TO A HALF INCH IRON PIPE SET ON THE CENTERLINE OF TOWNSHIP ROAD 23 AND HAVING PASSED THROUGH A HALF INCH IRON PIPE SET WITH CAP 5647 AT 748.44 FEET.

THENCE NORTH 90 DEGREES 00 MINUTES 00 SECONDS EAST ON A LINE FOR A DISTANCE OF 730.94 FEET TO A RAILROAD SPIKE.

THE PLACE OF BEGINNING AND CONTAINING 12.8940 ACRES MORE OR LESS WITH 0.3356 ACRES IN ROAD RIGHT OF WAY, BUT SUBJECT TO ALL LEGAL HIGHWAYS AND EASEMENTS OF RECORD AS SURVEYED BY JERRY B. WEININGER, REGISTERED SURVEYOR #5647 OF 6569 COUNTY HIGHWAY 2, McCUTCHENVILLE, OHIO 44844-0186 IN APRIL 12, 2016 AND MAY 2, 2016.

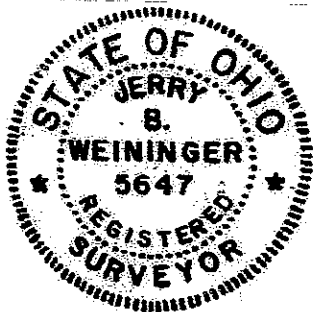

Jerry B. Weininger

REFERENCE SURVEY VOL. B
PAGE 150 IN THE TAX MAP OFFICE

"2016"



Scale: 1 Inch = 144 Feet
Area: 12.894 Acres (561,683.60 Square Feet)

PLAT CLOSURE

Area: 12.894 Acres (561,683.60 Square Feet)
Perimeter: 2998.76 Feet
Gap = 0.000

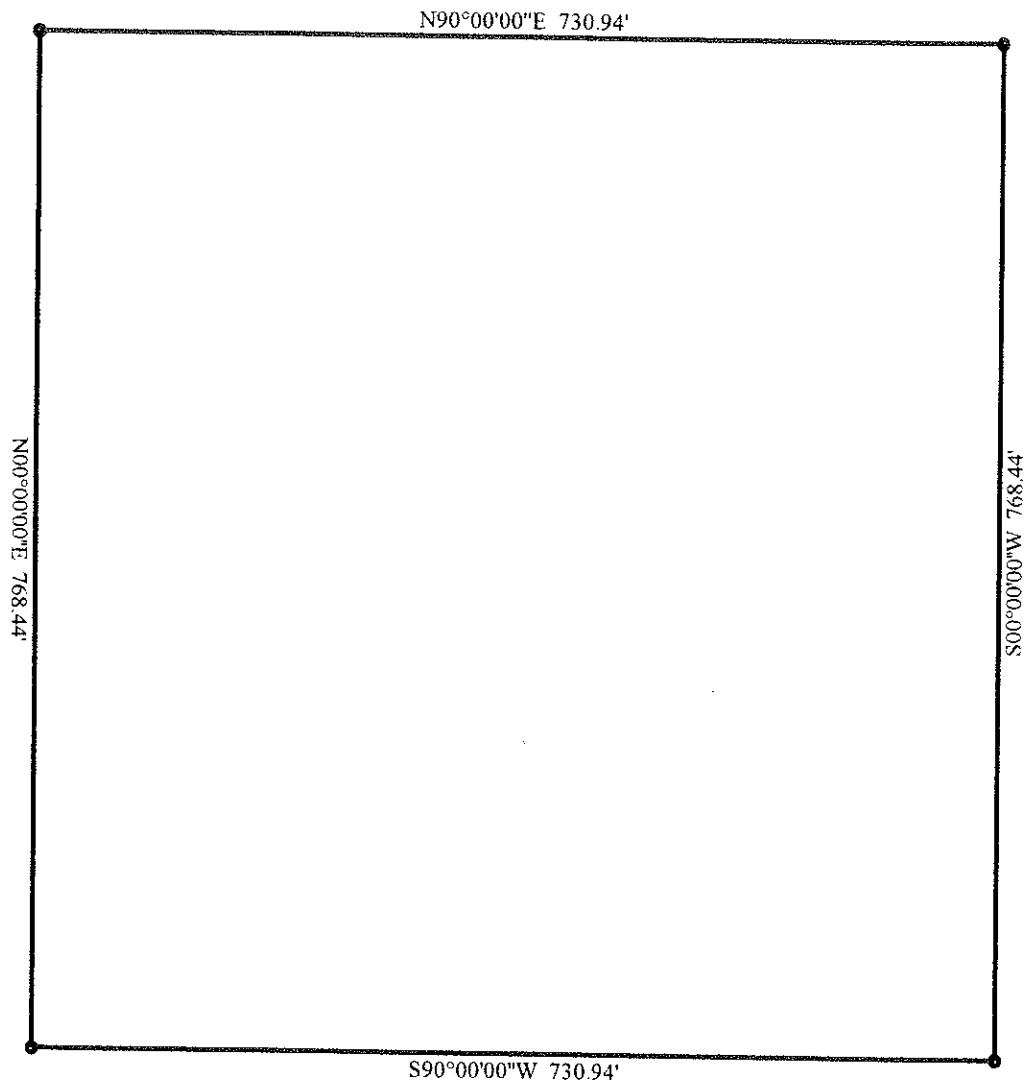

Errors and Omissions Excepted.

1. S00°00'00\"W 768.44'
2. S90°00'00\"W 730.94'
3. N00°00'00\"E 768.44'
4. N90°00'00\"E 730.94'

REFERENCE SURVEY VOL. B
PAGE 150 IN THE TAX MAP OFFICE

"2016"