

DESCRIPTION
0.762 ACRE

Being part of the Northeast Quarter and Northwest Quarter of Section 35, T-3-S, R-14-E, Pitt Township, Wyandot County, State of Ohio; and being more particularly described as follows;

Beginning at an existing survey nail located at the intersection of the centerline of County Road 113 (now being 60 feet wide) with the South Reservation Line;

Thence along said South Reservation Line N 89° 47' 25" E (for basis of bearing, see Survey Volume C, Pg. 693 Wyandot County Engineer's Office) for a distance of 355.00 feet to a 5/8" dia. iron pin set on Grantor's East Line (passing over an existing iron pin at 35.86 feet);

Thence along Grantor's East Line S 0° 12' 35" E for a distance of 103.40 feet to an existing iron pin on Grantor's South Line;

Thence along Grantor's South Line S 89° 47' 25" W for a distance of 286.96 feet to an existing survey nail on the centerline of County Road 113 (passing over an existing iron pin at 251.10 feet);

Thence along said centerline N 33° 33' 15" W for a distance of 123.78 feet to an existing survey nail on the South Reservation Line and the point of beginning.

Containing 0.762 acre more or less, and being subject to legal highways, easements, restrictions, and agreements of record. This description prepared from a survey performed by Thomas L. Boblenz, Registered Surveyor 5719, and dated April 13, 2007. All 5/8" dia. iron pins set have a plastic identity cap with the following caption, "TLB & Associates."

12685

REFERENCE SURVEY VOL. B
PAGE 133 IN THE TAX MAP OFFICE

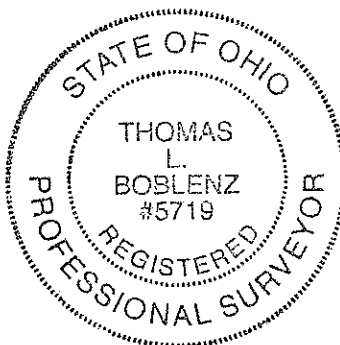

Thomas L. Boblenz
4-16-07