

Mic no 7, med
March
1982

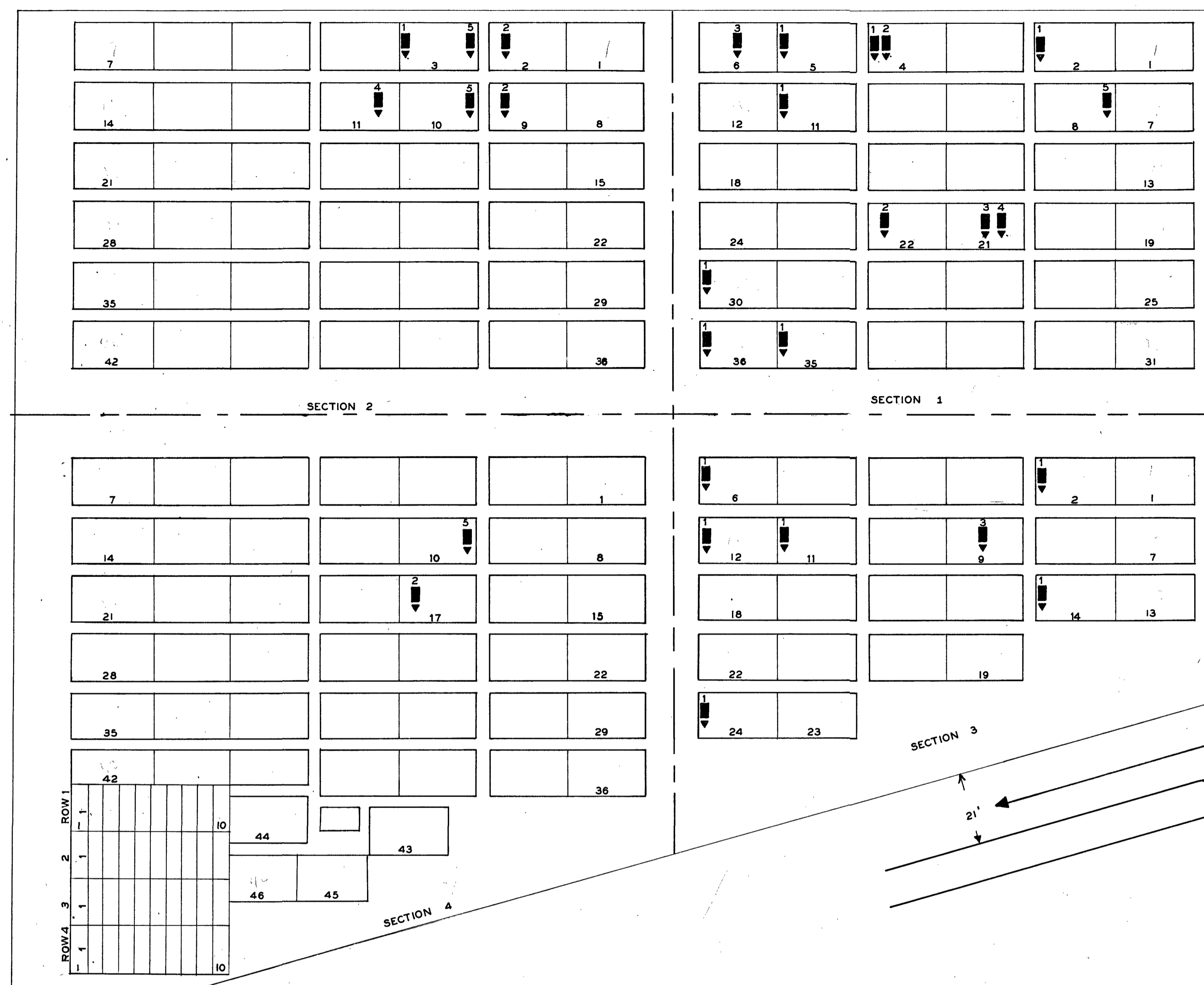

NAME	SEC	L	R	G	W
CAREY ARCHIBOLD	3	12		1	
CLARK JAMES W.	1	5		1	19
COZIER PAUL EDWIN	1	11		1	19
DAVIS GEORGE W.	1	6		3	19
DAWSON WM.	3	9		3	25
ELLIS J. H.	3	2		1	19
EMPTAGE JAMES A.	2	10		5	19
EMPTAGE THOMAS H.	2	9		2	19
EMPTAGE WM. J.	2	3		1	19
HARNESS GEO. B.	2	2		2	19
HOLMES BENJAMIN F.	1	35		1	19
HILBRITH DAVID B.	2	11		4	19
KEMP DR. G.W.	3	24		1	19
KENNEDY ELIJAH	2	3		5	19
KENNEDY JEROME	1	2		1	19
KRISHER LEMUEL	3	6		1	19
LINDSEY ROBERT R.	3	14		1	19
RENICK ABEL	1	4		2	10
RENICK WILLIAM H.	1	4		1	
ROBINSON HENRY	3	11		1	19
ROSE GEO. W.	1	22		1	19
SECORD ADELBERT A.	1	8		5	19
SIMPSON J. F.	1	21		3	19
WHITE JACKSON G.	1	21		4	19
WILLARD REUBEN L.	1	30		1	19
WILLIAMS GUY A.	4	17		2	25
WILLIAMS JACOB	4	10		5	19
YANCER S.	1	36		1	19

LEGEND
SEC = SECTION L = LOT R = ROW
G = GRAVE W = WAR
* POSITION UNKNOWN

**FEHL
CEMETERY**
WYANDOT CO. MARSEILLES TWP.
OFFICIAL PROJECT N^o465-42-3-467&665-42-3-232

LEGEND
① REVOLUTIONARY WAR
⑩ WAR OF 1812
⑪ MEXICAN WAR
⑰ CIVIL WAR
⑳ SPANISH-AM WAR
㉑ WORLD WAR

SCALE 1" = 20' 2.65 ACRES

88-6-1

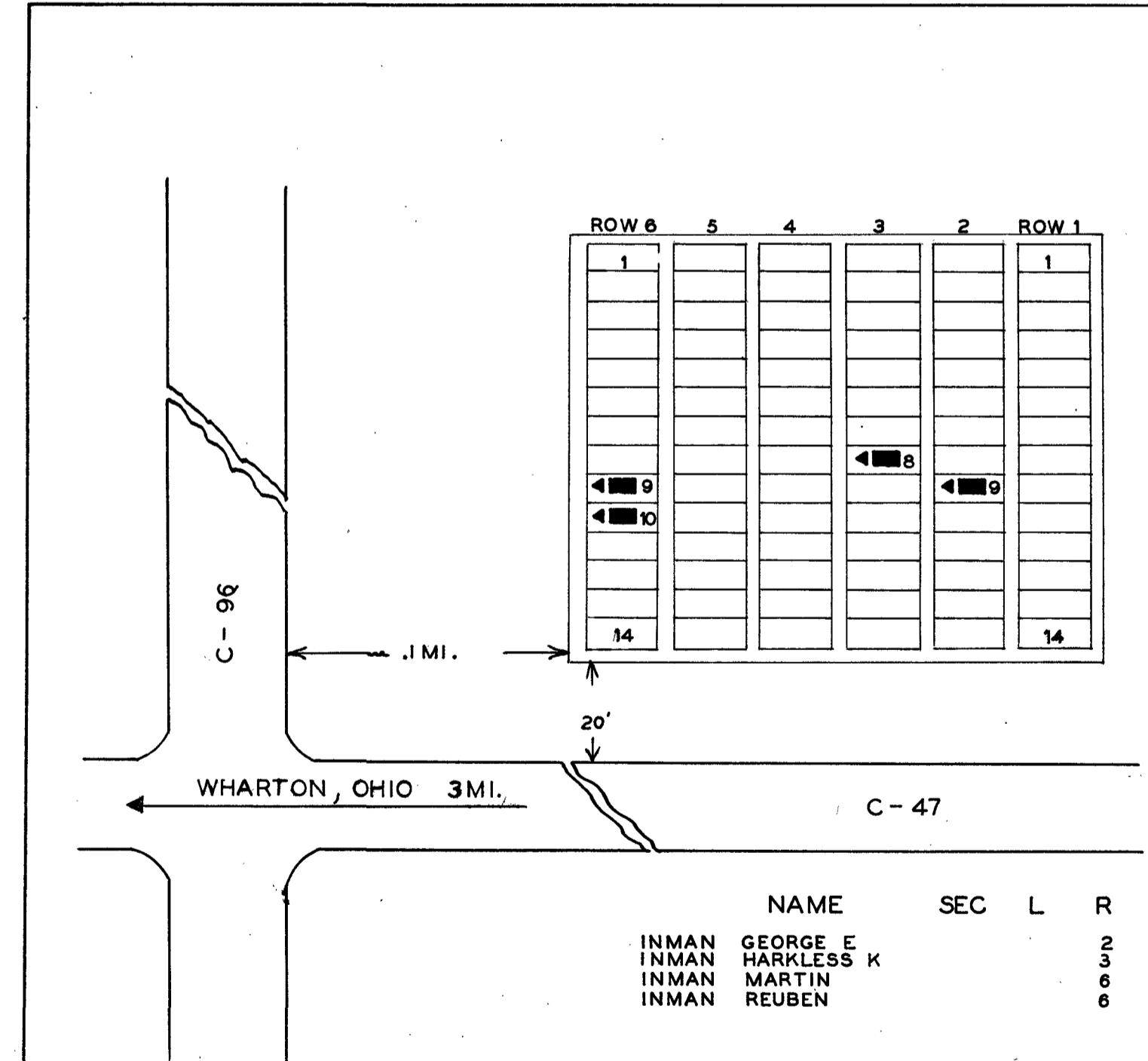

NAME	SEC	L	R	G	W
INMAN GEORGE E.	2	9		9	19
INMAN HARKLESS K.	3	8		8	19
INMAN MARTIN	6	10		10	19
INMAN REUBEN	6	9		9	19

**INMAN
CEMETERY**
WYANDOT CO. SALEM TWP.
OFFICIAL PROJECT N^o465-42-3-467&665-42-3-232

LEGEND
① REVOLUTIONARY WAR
⑩ WAR OF 1812
⑪ MEXICAN WAR
⑰ CIVIL WAR
⑳ SPANISH-AM WAR
㉑ WORLD WAR

SCALE 1" = 20' .25 ACRES

88-11-3